



Art. **N30023**

CITROËN JUMPER

 1/94→3/06

FIAT DUCATO

 7/94→6/06

PEUGEOT BOXER

 2/94→3/06

KIT x6

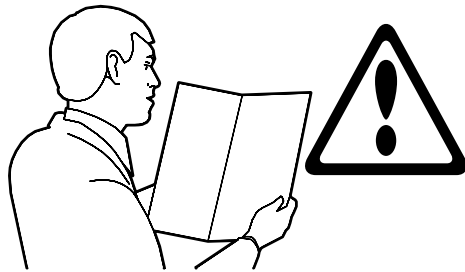
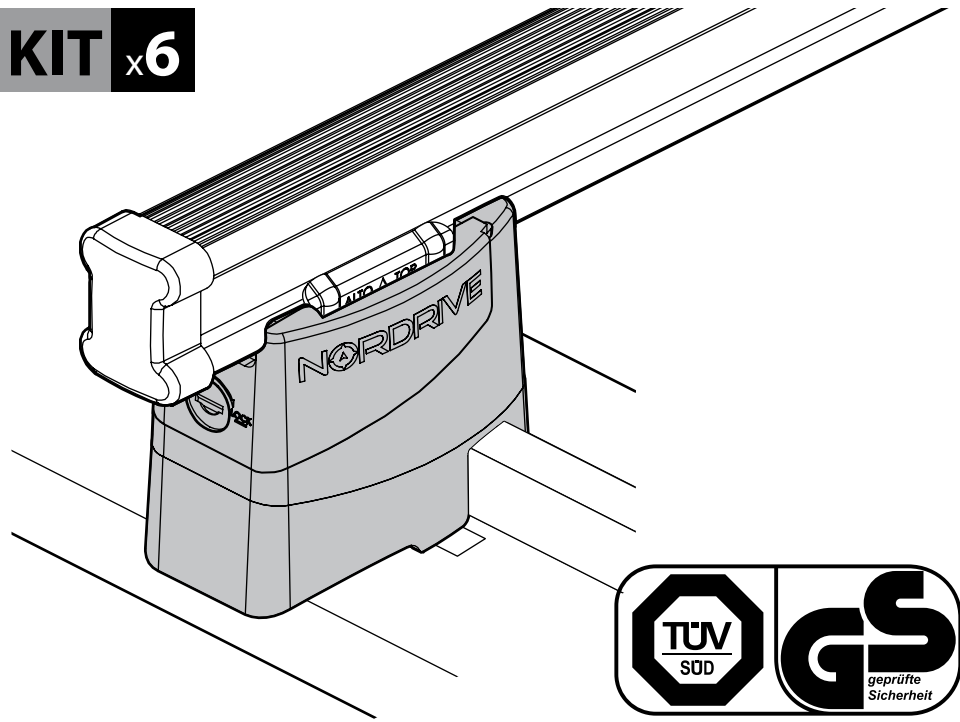

- ⓘ ADATTO PER
- Ⓒ SUITABLE FOR
- Ⓕ INDIQUÉ POUR
- Ⓓ GEEIGNET FÜR
- Ⓔ ADECUADA PARA

**NORDRIVE
KARGO SERIES**

- ⓘ ISTRUZIONI DI MONTAGGIO
- Ⓒ FITTING INSTRUCTIONS
- Ⓓ MONTAGEANLEITUNG
- Ⓕ INSTRUCTIONS DE MONTAGE
- Ⓔ ISTRUCCIONES DE MONTAJE
- Ⓖ INSTRUÇÕES DE MONTAGEM
- Ⓗ MONTAGE-INSTRUCTIES
- Ⓒ MONTERINGSANVISNING
- Ⓕ ASENNUSOHJE
- Ⓔ PAIGALDUSJUHEND
- Ⓕ STIPRINĀŠANAS INSTRUKCIJA
- Ⓕ PRITVIRTINIMO INSTRUKCIJOS
- Ⓕ INSTRUKCJA MONTAŻU
- Ⓕ Инструкции по установке
- Ⓕ NÁVOD NA MONTÁŽ
- Ⓕ NÁVOD NA MONTÁŽ
- Ⓕ NAVODILA ZA PRITRJEVANJE
- Ⓕ UPUTA ZA SASTAVLJANJE
- Ⓕ A FELSZERELÉS MÓDJA
- Ⓕ Οδηγίες συναρμολόγησης
- Ⓕ MONTAJ TALIMATLARL
- Ⓕ ИНСТРУКЦИИ ЗА МОНТАЖ
- Ⓕ UPUTSTVA ZA MONTAŽU



Kargo
ACCIAIO
Steel

- ⓘ BARRE KARGO
- Ⓒ KARGO BARS
- Ⓕ BARRES KARGO
- Ⓓ DACH-LASTENTRÄGER KARGO
- Ⓔ BARRES KARGO

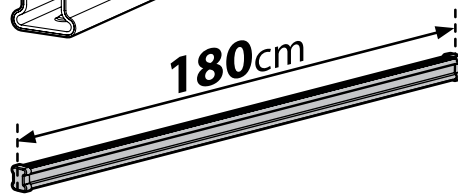

Art. **N10015** x3



Kargo-Plus
ALLUMINIO
Aluminium

- ⓘ BARRE KARGO-PLUS
- Ⓒ KARGO-PLUS BARS
- Ⓕ BARRES KARGO-PLUS
- Ⓓ DACH-LASTENTRÄGER KARGO-PLUS
- Ⓔ BARRES KARGO-PLUS

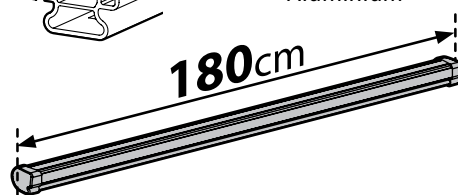

Art. **N10045** x3



KRS-7

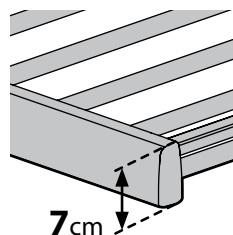

7cm

KRS-12

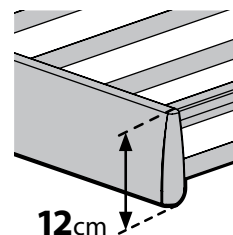

12cm

- ⓘ CESTE PORTATUTTO KRS-7 / KRS-12
- Ⓒ KRS-7 / KRS-12 VAN ROOF RACKS
- Ⓕ GALERIE KRS-7 / KRS-12
- Ⓓ DACHKÖRBEIN KRS-7 / KRS-12
- Ⓔ BACAS KRS-7 / KRS-12

NORDRIVE®

TRANSPORT SOLUTIONS

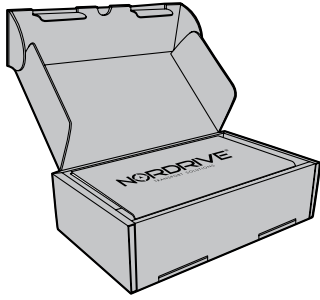

NORDRIVE®

TRANSPORT SOLUTIONS

Art. **N30023**

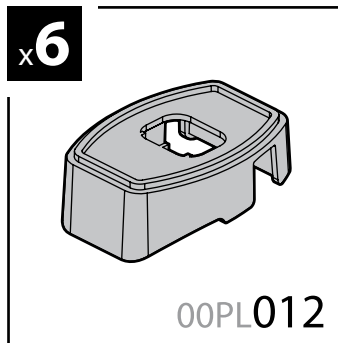
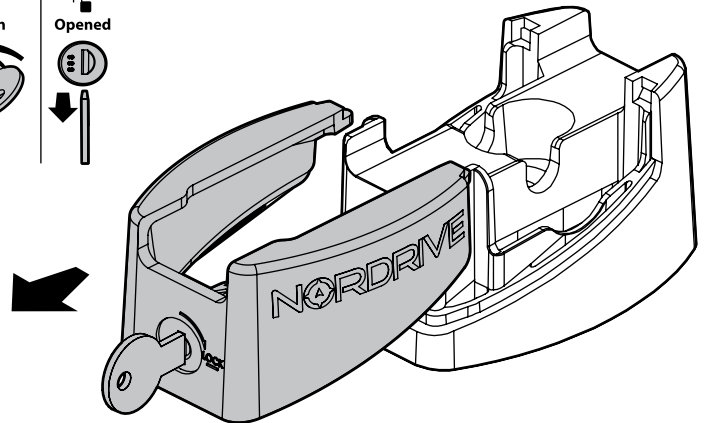
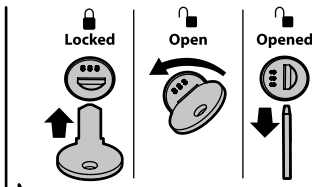
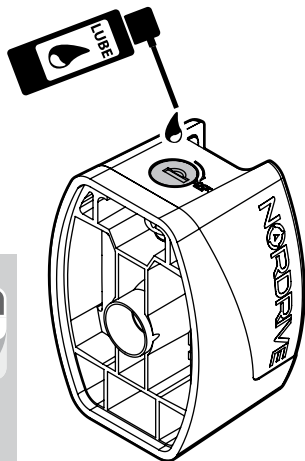
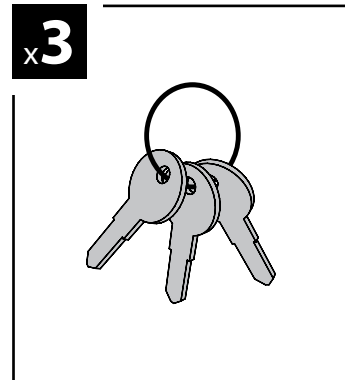
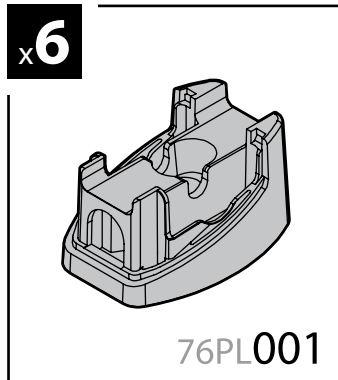
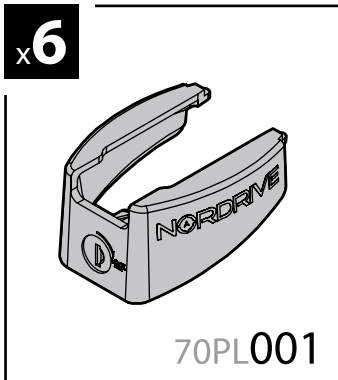

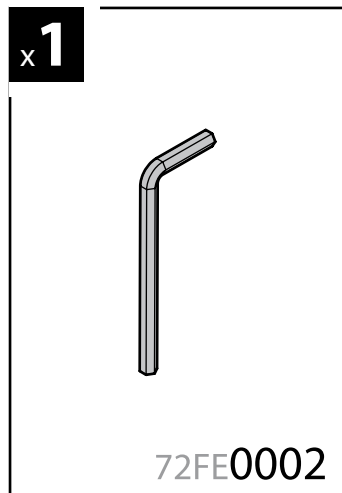
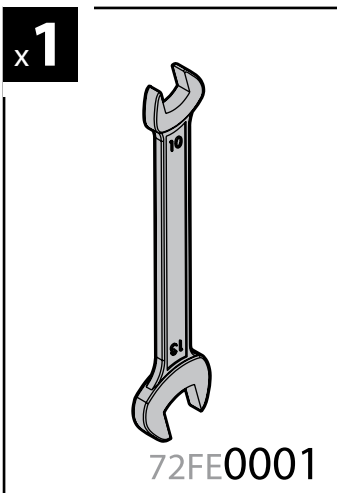
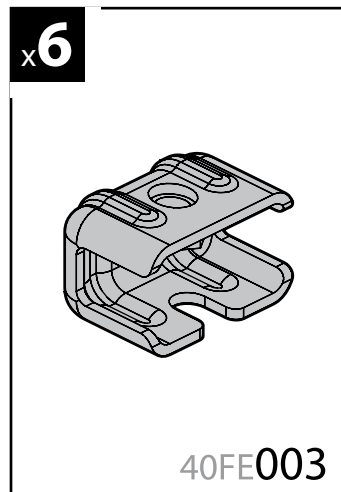
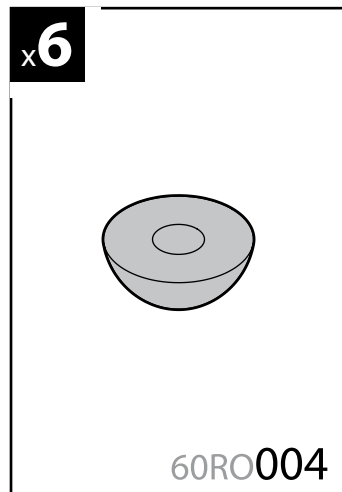
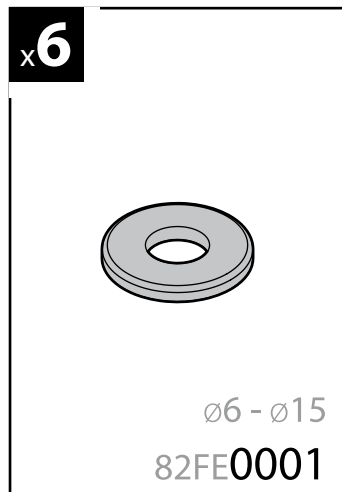
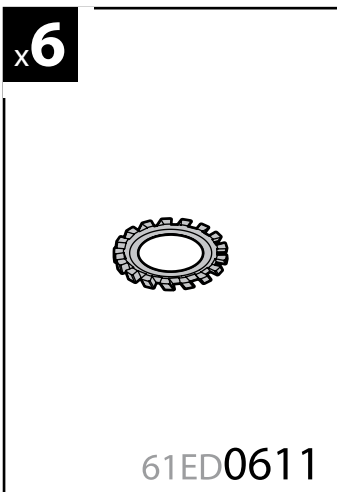
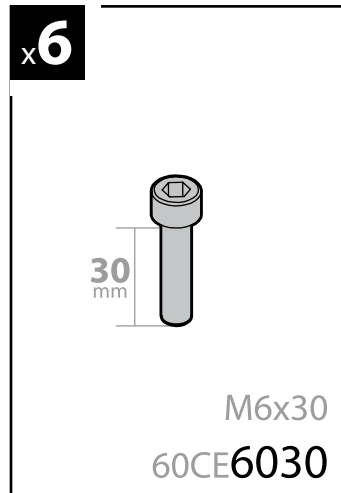
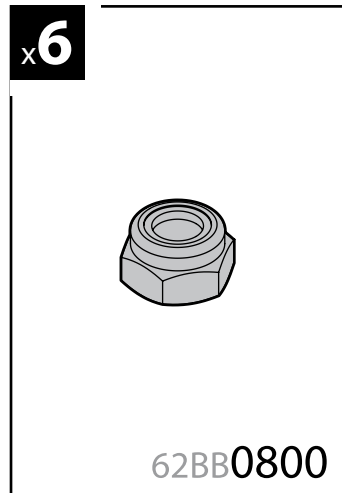
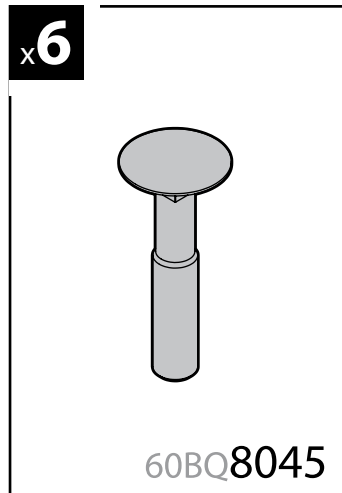
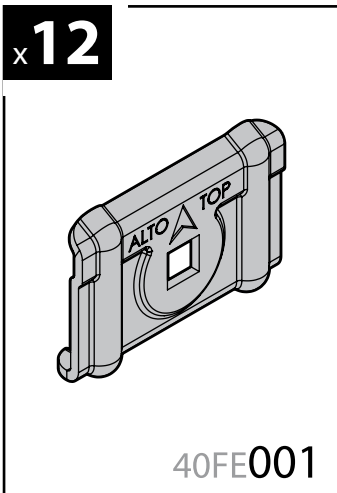

ⓘ ISTRUZIONI DI MONTAGGIO
ⓖᔡ FITTING INSTRUCTIONS
ⓓ MONTAGEANLEITUNG
ⓕ INSTRUCTIONS DE MONTAGE
ⓔ ISTRUCCIONES DE MONTAJE
ⓖ INSTRUÇÕES DE MONTAGEM
Ⓝᓚ MONTAGE-INSTRUCTIES
Ⓢ MONTERINGSANVISNING

ⓕᓗᓗ ASENNUSOHJE
ⓔᓄᓄ PAIGALDUSJUHEND
ⓕᓗᓄ STIPRIŅĀŠANAS INSTRUKCIJA
ⓕᓗᓄ PRITVIRTINIMO INSTRUKCIJOS
ⓕᓗᓄ INSTRUKCJA MONTAŻU
ⓕᓗᓄ Инструкции по установке
ⓕᓗᓄ NÁVOD NA MONTÁŽ
ⓕᓗᓄ NÁVOD NA MONTÁŽ

ⓕᓗᓄ NAVODILA ZA PRITRJEVANJE
ⓕᓗᓄ UPUTA ZA SASTAVLJANJE
ⓕᓗᓄ A FELSZERELÉS MÓDJA
ⓕᓗᓄ Οδηγίες συναρμολόγησης
ⓕᓗᓄ MONTAJ TALIMATLARL
ⓕᓗᓄ ИHCTPYKЦИИ ЗА MONTAЖ
ⓕᓗᓄ UPUTSTVA ZA MONTAŽU

1

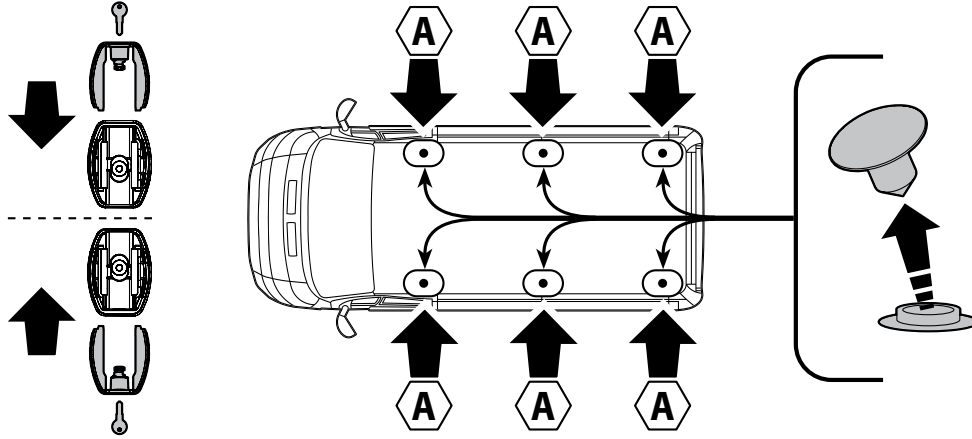

2

A

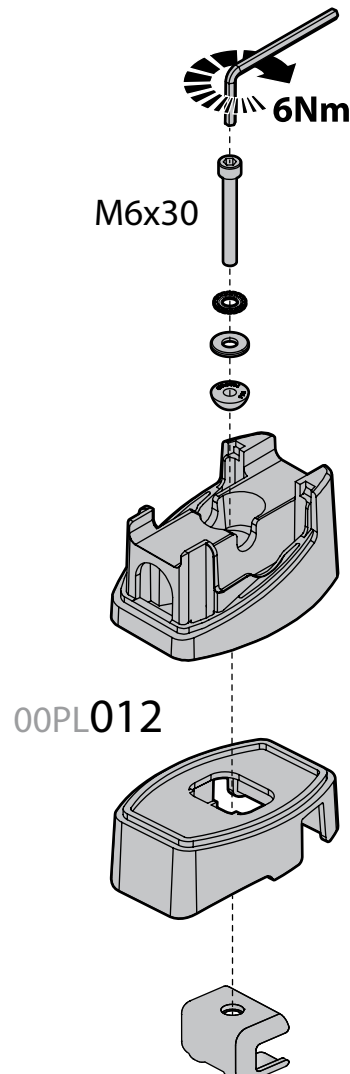

3

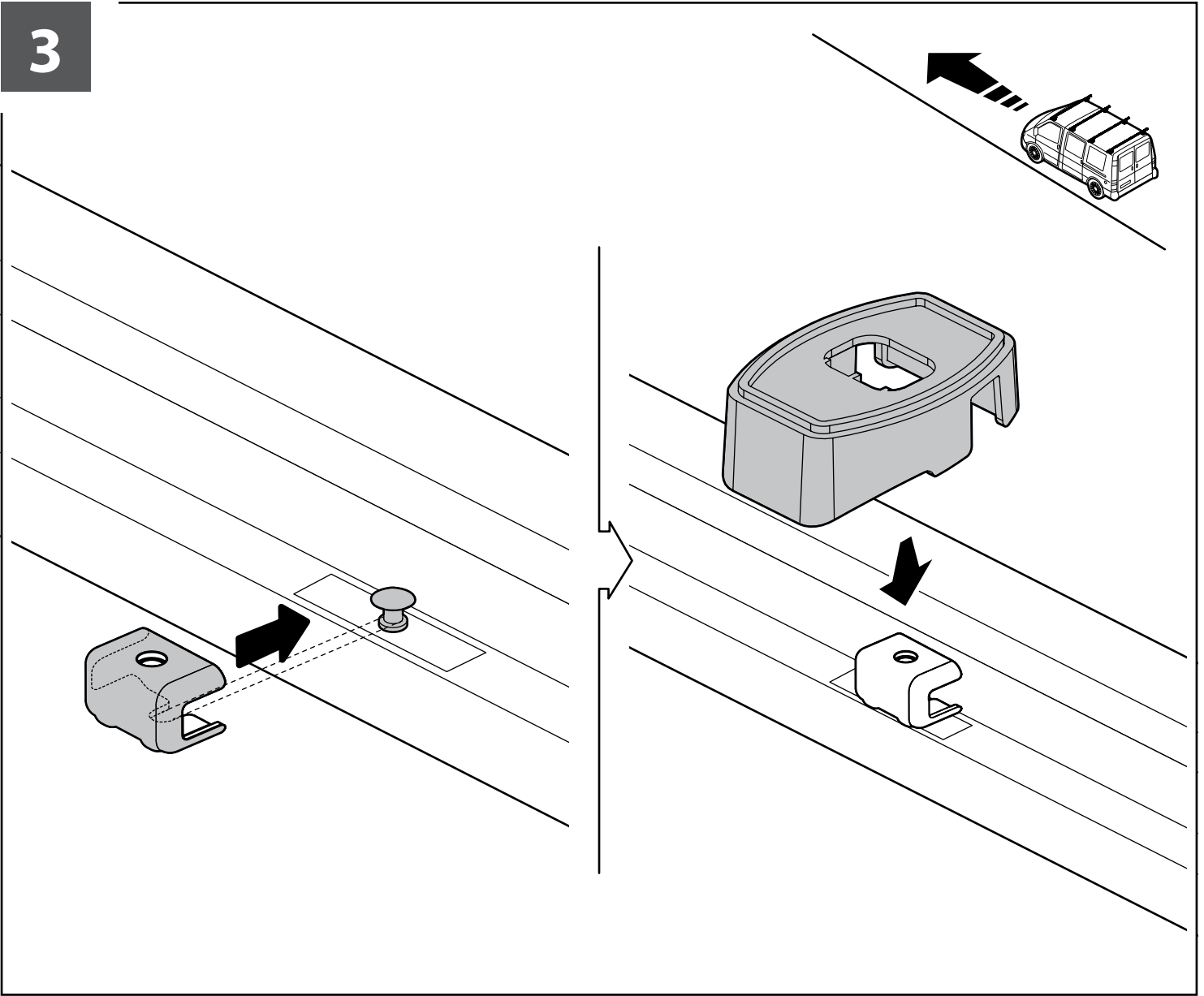

4

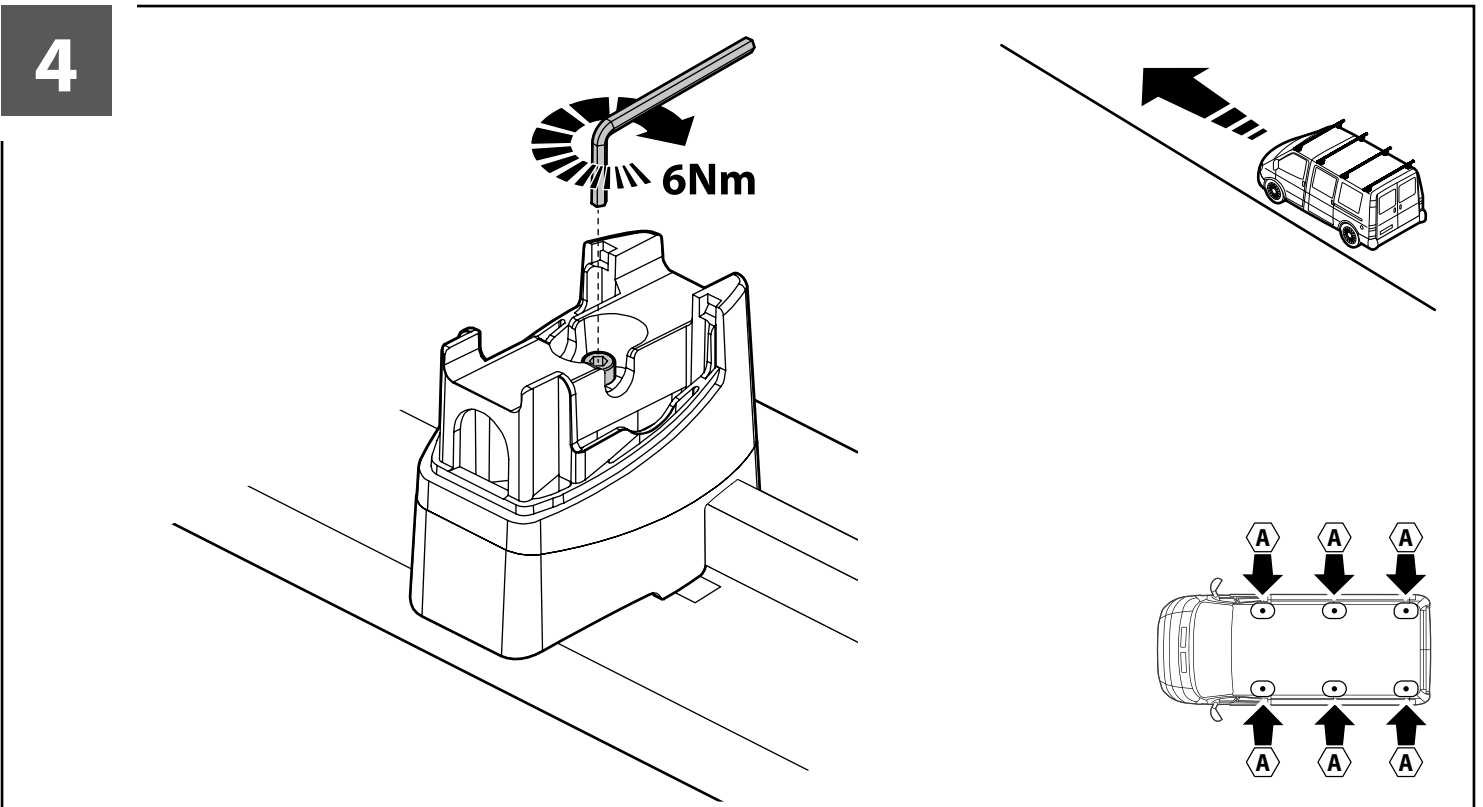



ATTENZIONE WARNING



A Kargo

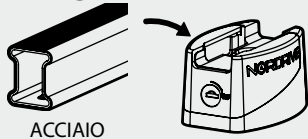

ACCIAIO
Steel

MONTAGGIO DIRETTO
SUI KIT PIEDI SPECIFICI
DIRECTLY ON FOOT KITS
BEFESTIGUNGSFÜSSE

B Kargo-Plus

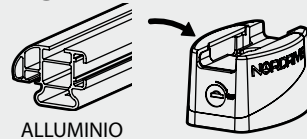

ALLUMINIO
Aluminium

MONTAGGIO DIRETTO
SUI KIT PIEDI SPECIFICI
DIRECTLY ON FOOT KITS
BEFESTIGUNGSFÜSSE

A

B

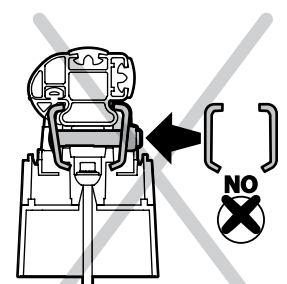
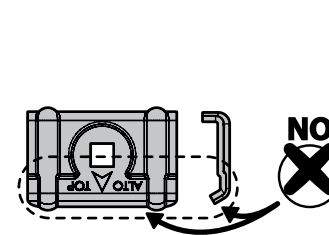
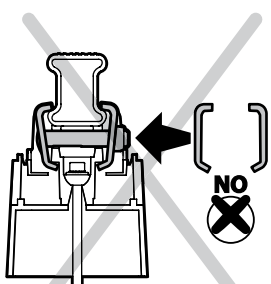
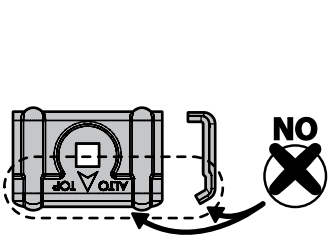
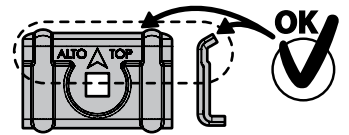
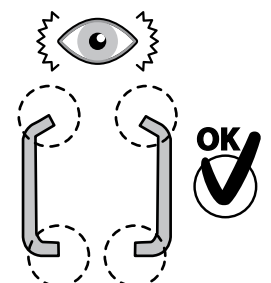
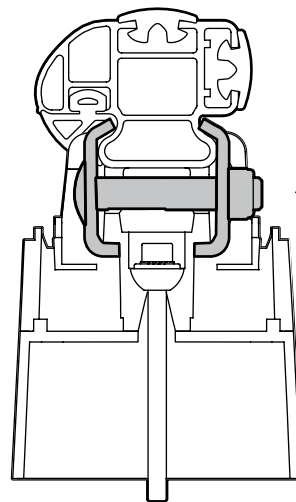
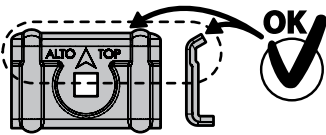
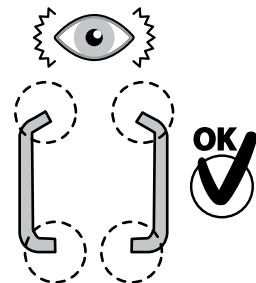
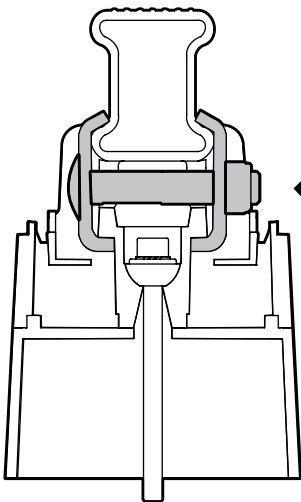
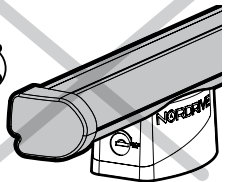
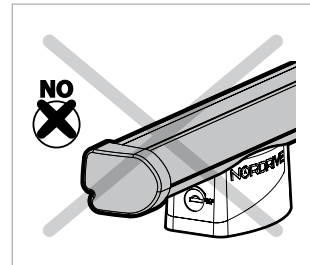
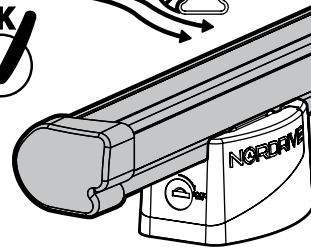
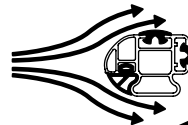
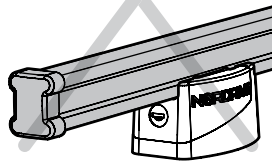
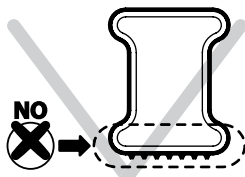
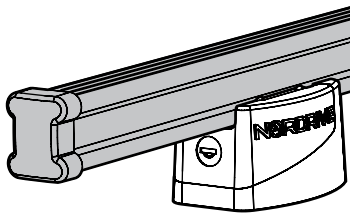
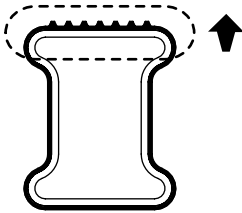

5

A

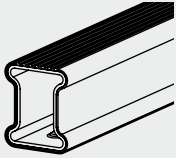

Kargo



ACCIAIO
Steel

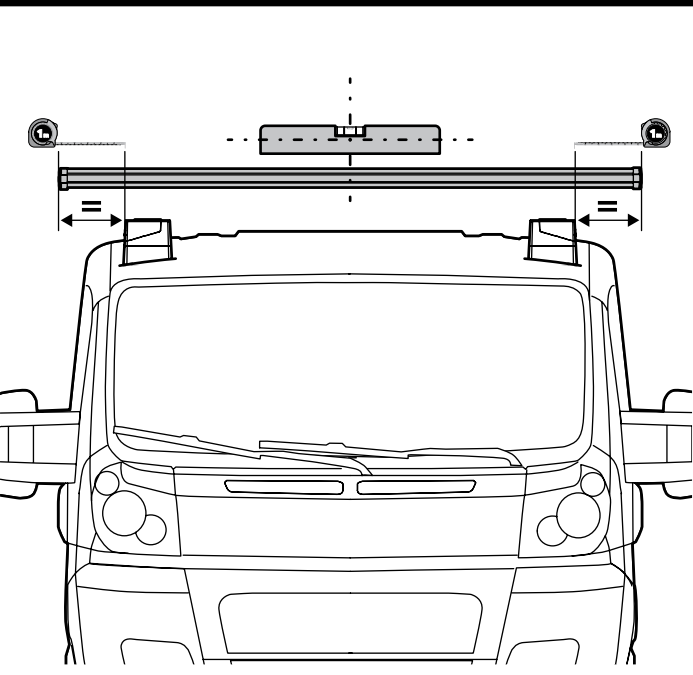
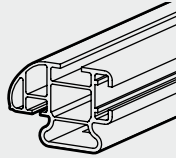



Diagram showing the Kargo steel bar being installed on a vehicle roof. The bar is positioned across the roof rails, and the diagram indicates the correct placement and alignment.

B



Kargo-Plus



ALLUMINIO
Aluminium

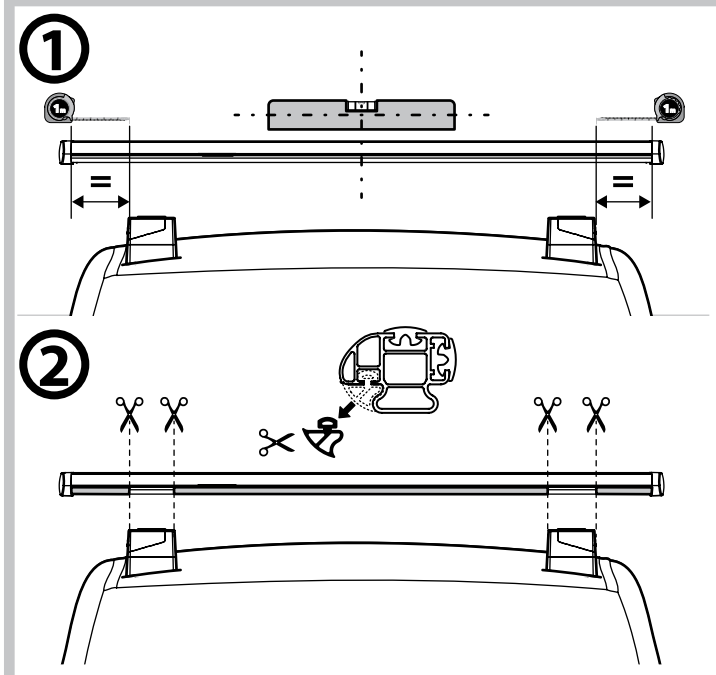

Diagram showing the Kargo-Plus aluminium bar being installed on a vehicle roof. Step 1 shows the bar being placed on the roof rails. Step 2 shows the bar being secured with clips, with scissors indicating where to cut the clips.

6

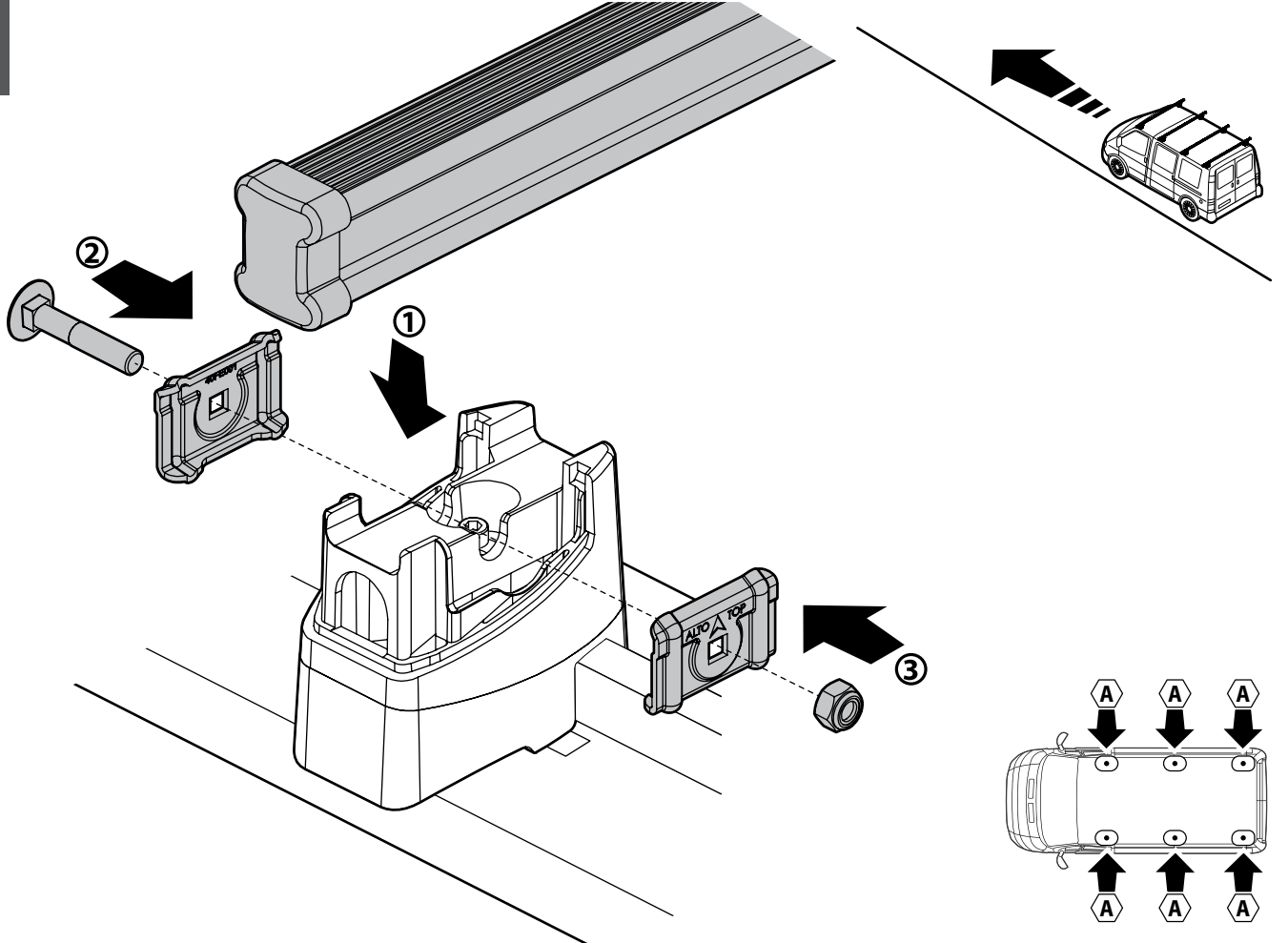
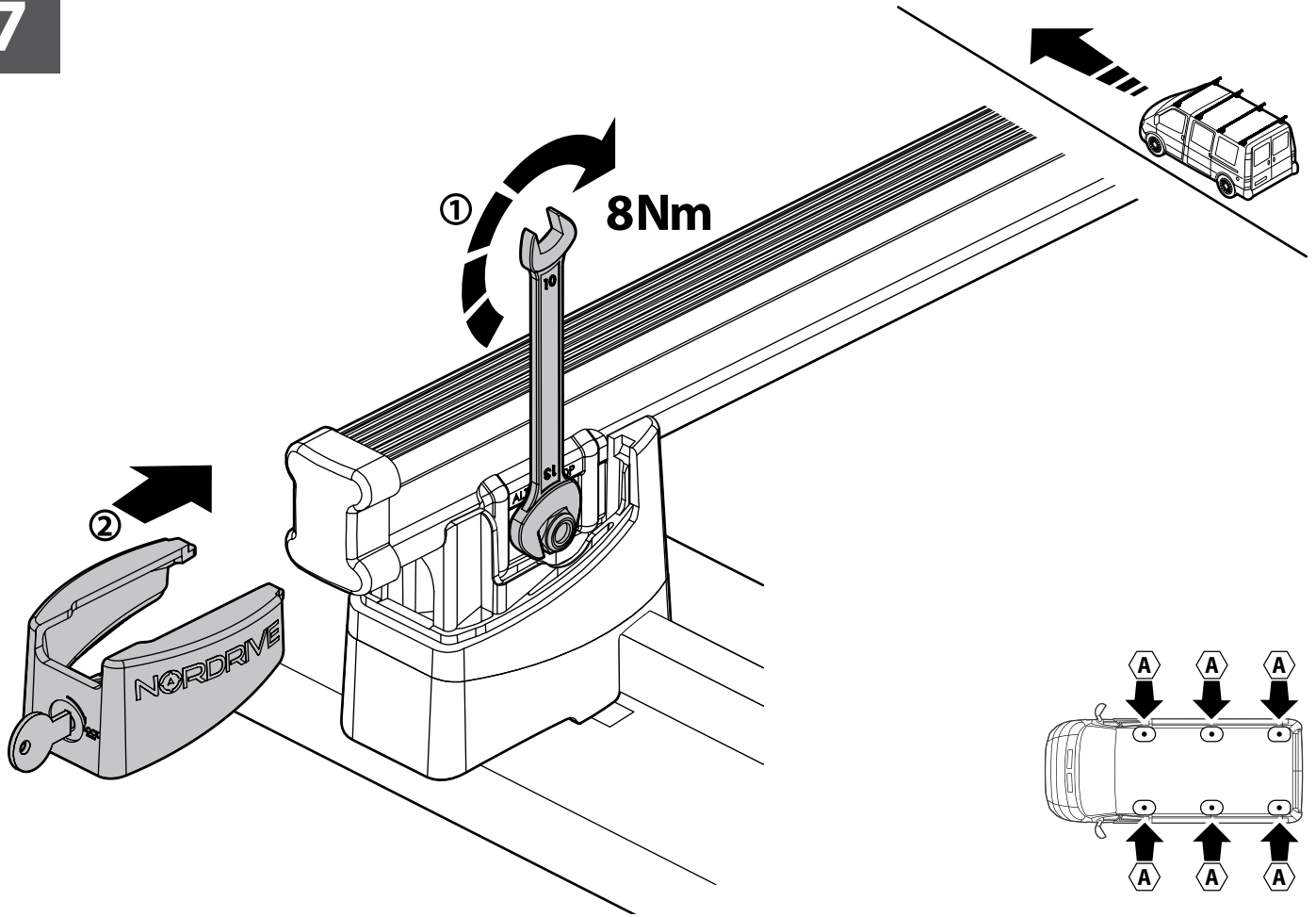
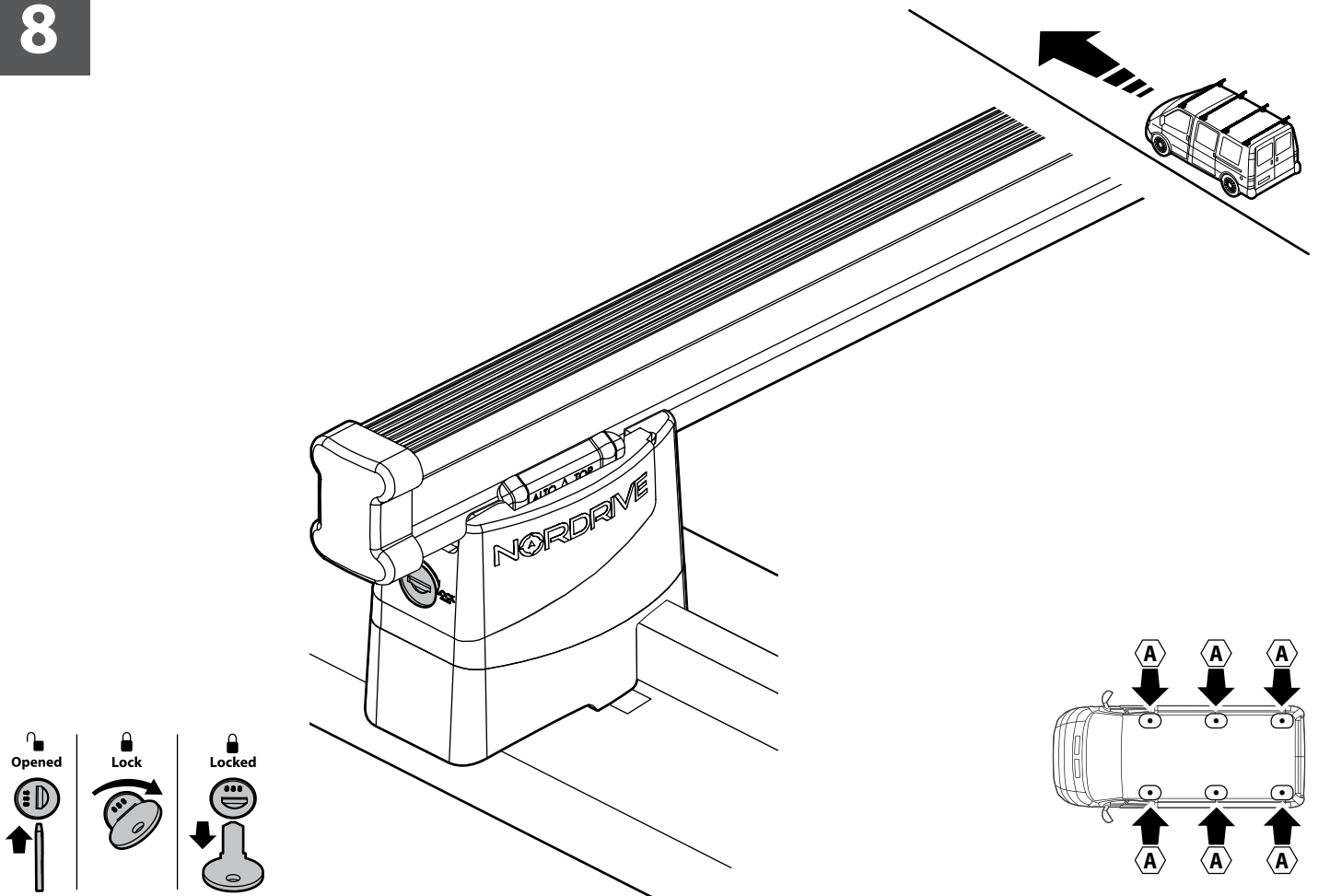

Diagram showing the assembly of the Kargo bar. Step 1 shows the bar being inserted into the base. Step 2 shows the bar being secured with a bolt. Step 3 shows the bar being secured with a nut. An inset diagram shows the bar being installed on a vehicle roof, with arrows indicating the correct placement.

7



8



Kargo series

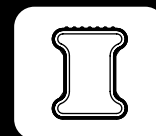

Acciaio / Steel

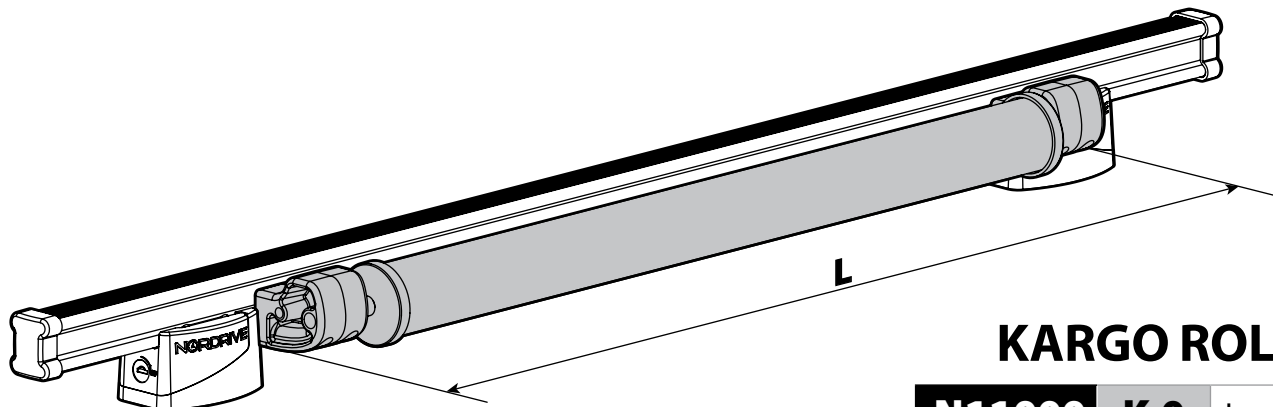

KARGO ROLLER

N11000	K-0	L = 64 cm
N11003	K-7	L = 96 cm

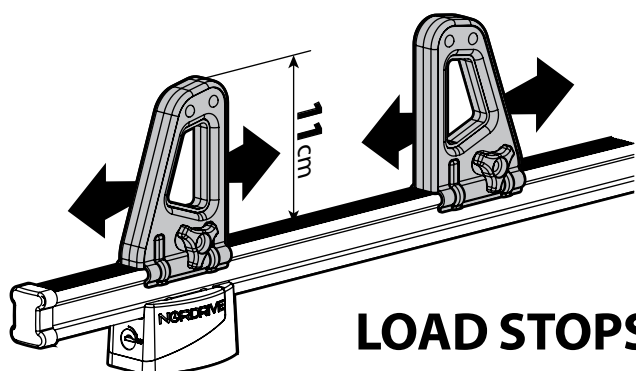

LOAD STOPS

N11001 K-1

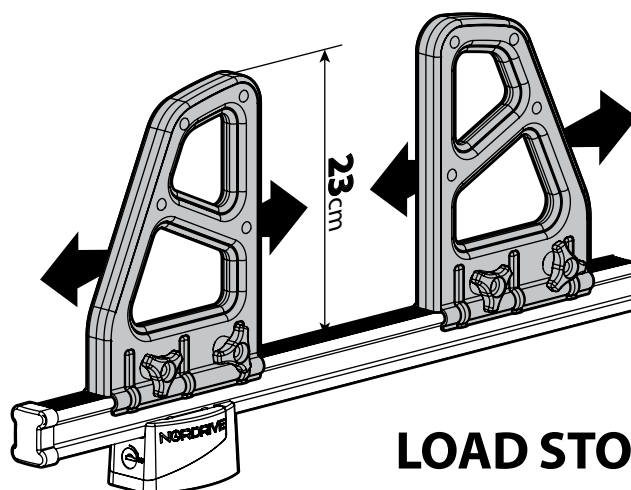

LOAD STOPS

N11002 K-2

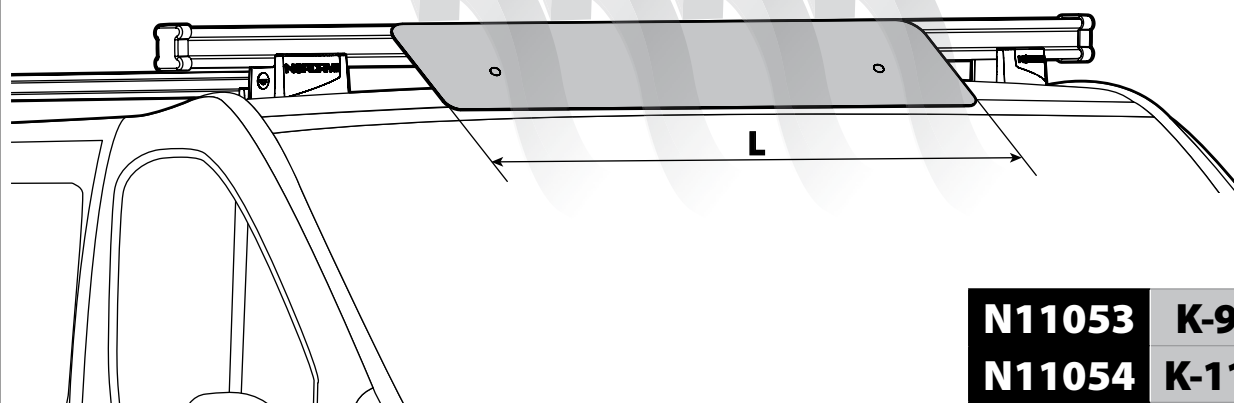

SPOILER

N11053	K-9	L = 95 cm
N11054	K-11	L = 110 cm

OPTIONALS PER / FOR / FÜR:

Kargo-Plus series

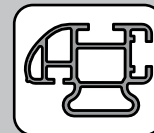

Alluminio / Aluminium

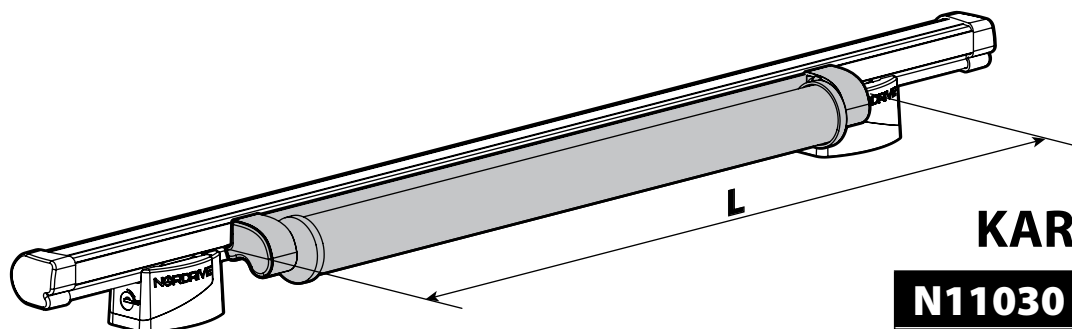

KARGO ROLLER

N11030 KP-0 L = 64 cm

N11034 KP-7 L = 96 cm

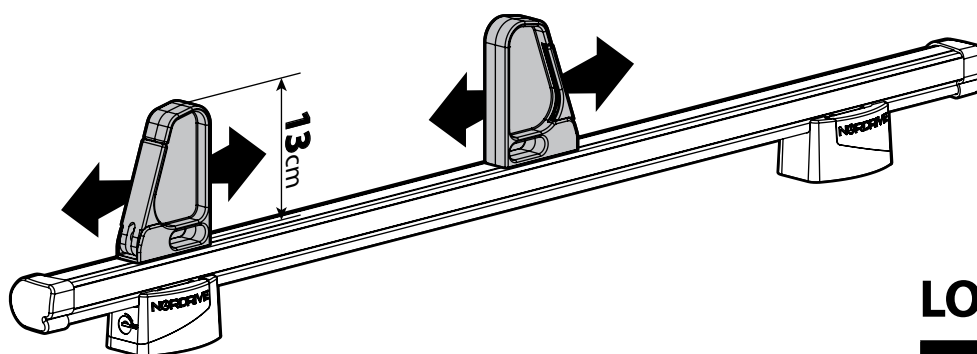

LOAD STOPS

N11031 KP-1

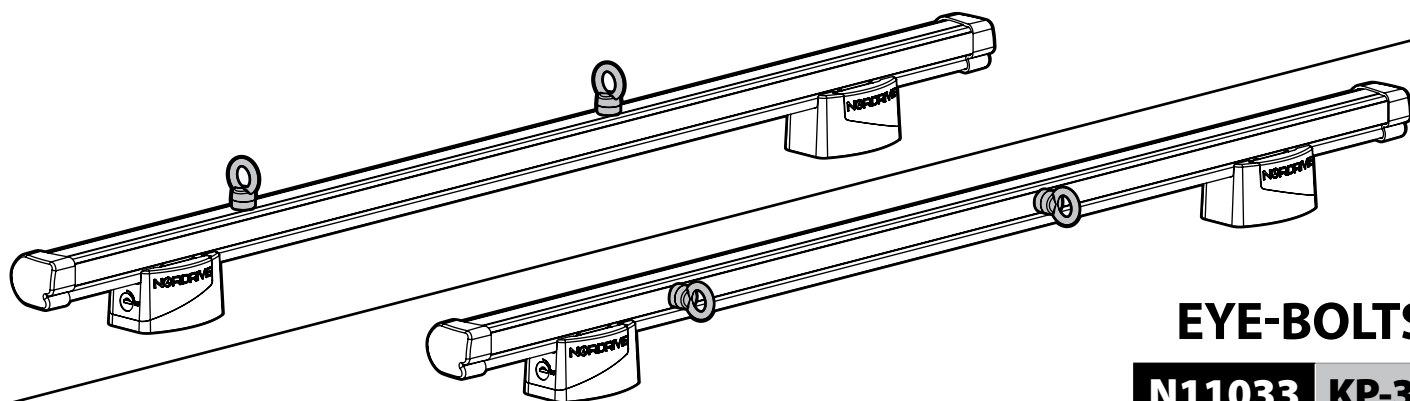

EYE-BOLTS

N11033 KP-3

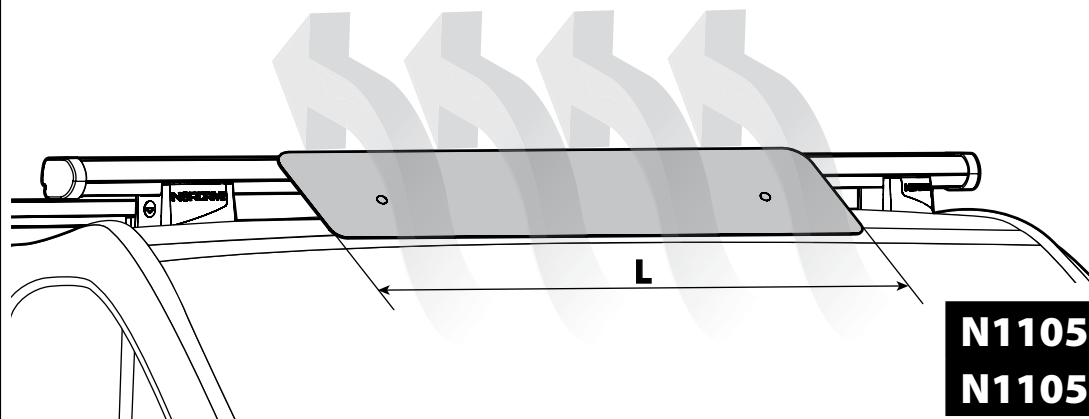

SPOILER

N11057 KP-9 L = 95 cm

N11058 KP-11 L = 110 cm

OPTIONALS PER / FOR / FÜR:

Kargo series



Acciaio / Steel

Kargo-Plus
series

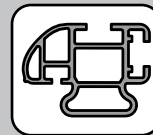

Alluminio / Aluminium

KARGO-TUBE

N11050	T200	L = 205 cm
N11051	T300	L = 305 cm
N11052	T400	L = 405 cm

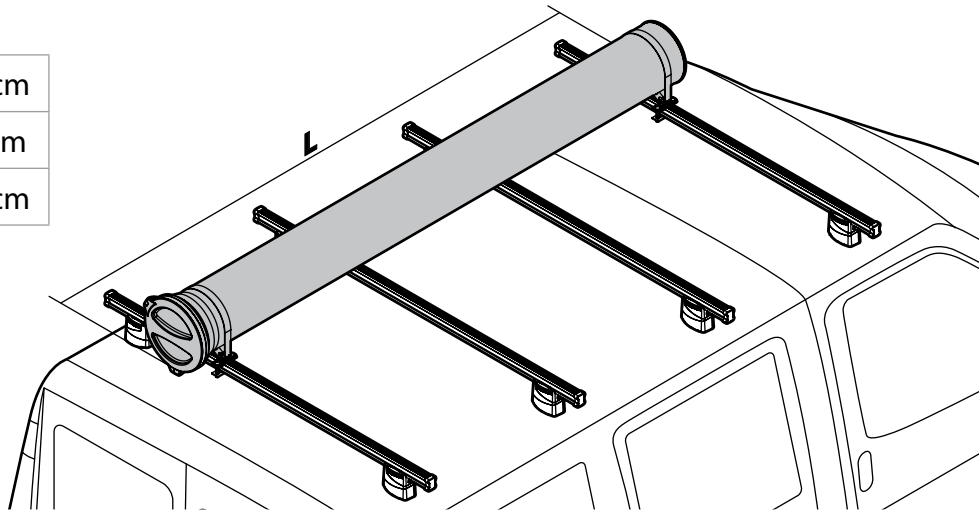

LADDER HOLDER STRAPS

N11065 U-5

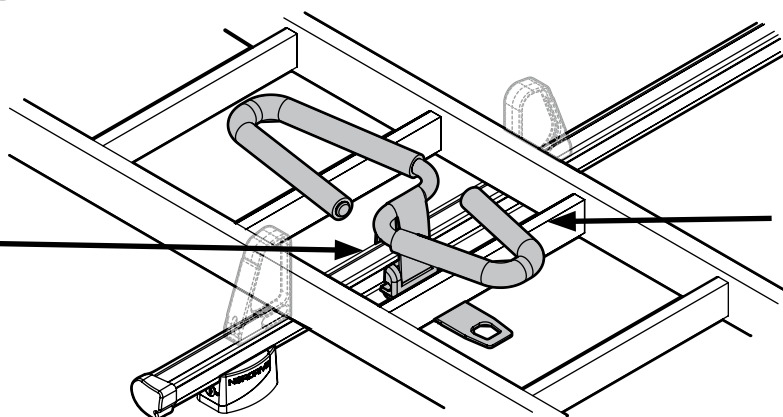
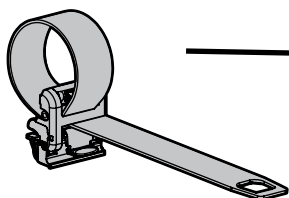

LADDER STEP ADAPTER

N11067 U-6

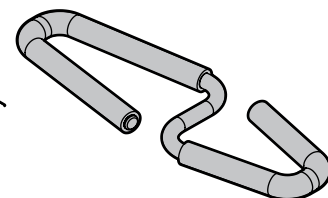

EXTENSION ROLLER

N11020	U-0	L = 64 cm
N11021	U-7	L = 96 cm

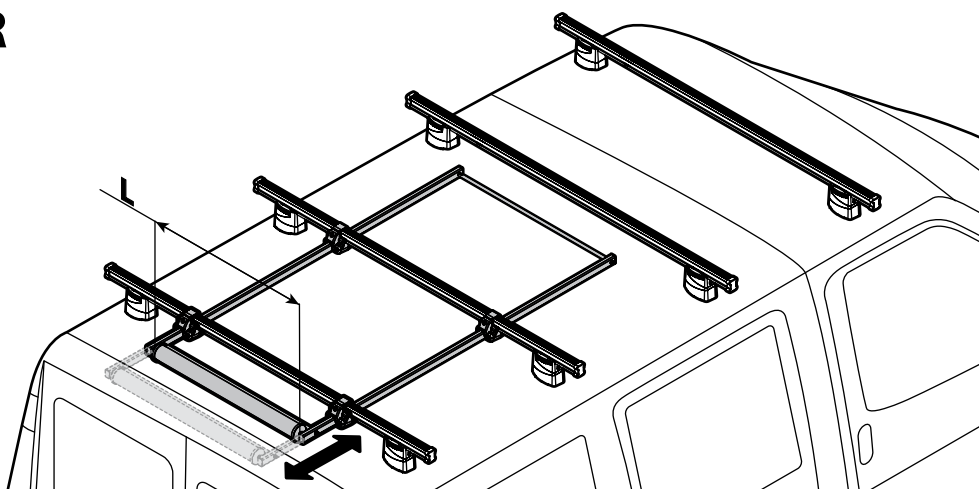

- (I) Lotto di produzione da comunicare per eventuali ricambi
- (GB) Production lot number to be communicated for any spare parts
- (F) Lot de production à communiquer pour toute pièce de rechange
- (D) Produktionscharge für eventuelle Ersatzteile
- (E) Lote de producción a comunicar por cualquier repuesto

Lot.

NORDRIVE®
TRANSPORT SOLUTIONS

NORDRIVE® is a registered trademark of
LAMPA S.p.A.
Via G. Rossa 53/55, 46019 Viadana (MN) ITALY
Tel. +39 0375 820700
UNI EN ISO 9001:2008 Certified Company
www.nordrive.it
www.lampa.it